



100% SUBMITTAL

UNINTECH CONSULTING ENGINEERS, INC.  
 3737 EXECUTIVE CENTER DR. #101 TBPE Reg. No. F-5499  
 AUSTIN, TEXAS 78731  
 PHONE: 512.579.0722 FAX: 512.579.0734 WWW.UNINTECH.COM

**LEGEND**

- PROPOSED TRAFFIC FLOW DURING DETOUR
- ⬇ SIGN
- ▬ TYPE III BARRICADE

- NOTES:**
1. REFER TO TXMUTCD, FIGURE 6H-19 "DETOUR FOR ONE TRAVEL DIRECTION (TA-19)" AND TXDOT BARRICADE AND CONSTRUCTION STANDARDS FOR TCP SIGNS PLACEMENT.
  2. REFER TO CONSTRUCTION STANDARDS FOR ADVANCED WARNING SIGNS PLACEMENT.

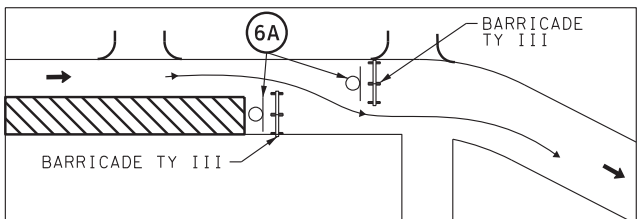

DETAIL "A"  
N.T.S.

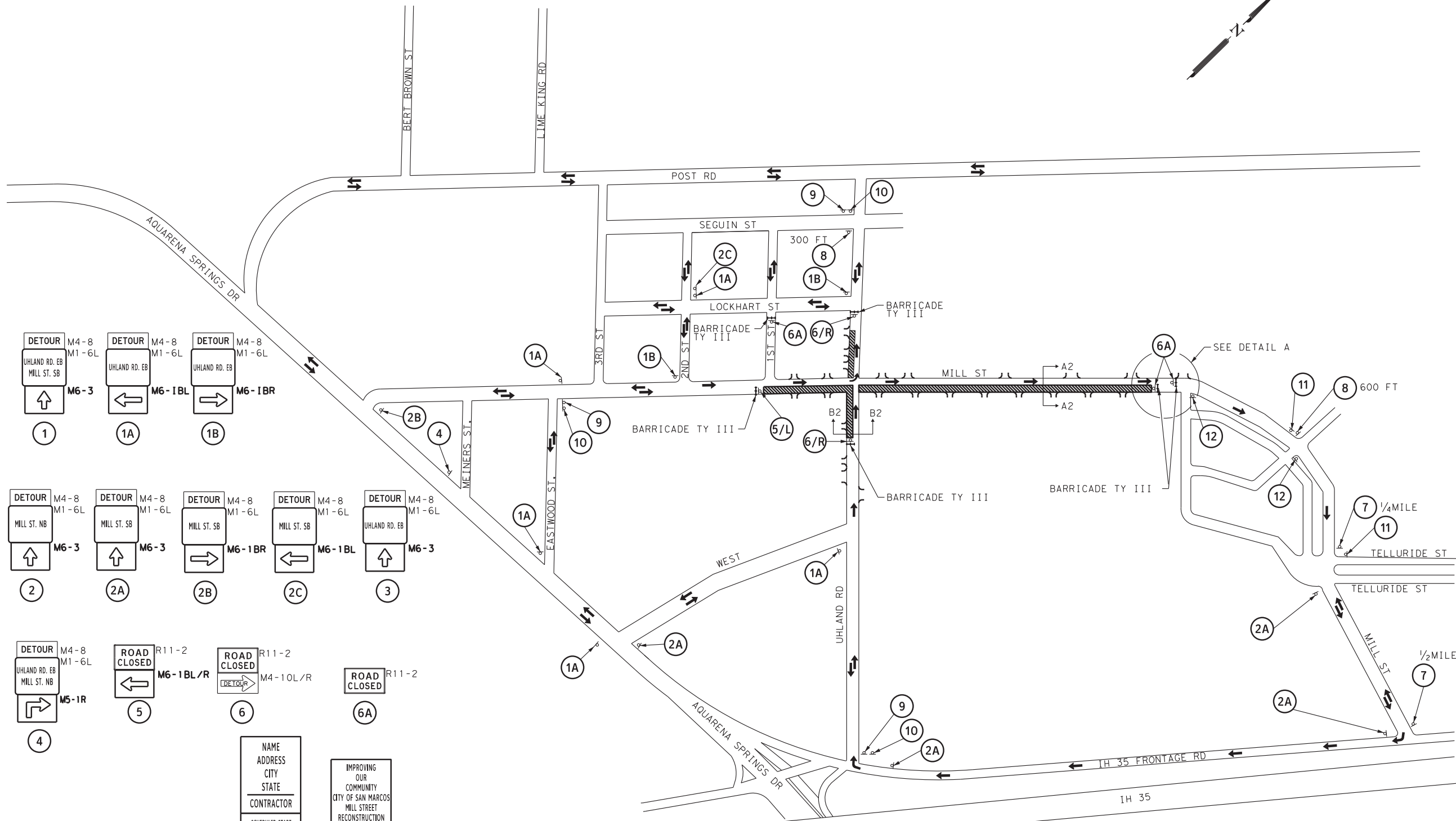
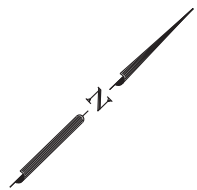

DETOUR ROUTE PHASE - II  
NOT TO SCALE

SCALE: N.T.S.

REV	DESCRIPTION	BY	DATE

7/25/2018  
 YUE ZHU  
 85643  
 REGISTERED PROFESSIONAL ENGINEER

**MILL STREET**

DETOUR LAYOUT  
PHASE II

Project No	C539
CS#	-
Client I.D.	XXXXXX
Drawn By	IZM
Checked By	Y. Z.
Scale	AS SHOWN
Date	7/25/2018
Sheet	1 of 1
Sheet No.	23

7/25/2018 3:31:06 PM  
 T:\2016\16-003-W Mill Street\TCP\MILL ST\*TCP-DETOUR-PH\*11.dgn

 1	 1A	 1B
 2	 2A	 2B
 2C	 3	 4
 5	 6	 6A
 7	 8	 9
 10	 11	 12

IMPROVING OUR COMMUNITY  
 CITY OF SAN MARCOS  
 MILL STREET RECONSTRUCTION PROJECT  
 FOR INFORMATION CALL 512-393-8130 OR VISIT  
 WWW.SANMARCOSTX.GOV/Construction